

n ≈ 1450 rpm

پمپ WKL4, WKL 4 100

تیپ پمپ	توان P		آمپر A	قطر پروانه D (mm)	قطر فلنج mm		Q آبدھی								
	KW	HP			مکش	رانس	m ³ /h	40	80	100	120	140	160	180	200
							l/s	11.1	22.2	27.8	33.3	38.9	44.5	50	55.6
WKL4 100.1 E	7.5	10	16	230	125	100	H (m)	18.5	16.8	15.5	13.6	11.6	9	6	*
WKL4 100.1 D	11	15	22	240				21	19	17.7	15.8	13.8	11.2	8.25	*
WKL4 100.1 C	11	15	22	250				23.4	21.5	20	18	16	13.5	10.5	*
WKL4 100.1 B	15	20	30	260				25	23.2	21.7	20	18	15.6	13	10
WKL4 100.1 A	15	20	30	265				27	25	23.5	21.8	19.7	17.5	15	12
WKL4 100.2 E	15	20	30	230				37	33.6	31	27.2	23.2	18	12	*
WKL4 100.2 D	18.5	25	38	240				42	38.2	35.4	31.7	27.6	22.5	16.5	*
WKL4 100.2 C	18.5	25	38	250				46.8	43	40	36.2	32	27	21	*
WKL4 100.2 B	22	30	43.5	260				50.2	46.4	43.4	39.8	35.8	31.2	25.8	20
WKL4 100.2 A	30	40	58	265				53.5	49.8	47	43.6	39.4	35	30	24
WKL4 100.3 E	22	30	43.5	230				55.5	50.4	46.5	40.8	34.8	27	18	*
WKL4 100.3 D	22	30	43.5	240				62.8	57.3	53	47.5	41.4	33.7	24.7	*
WKL4 100.3 C	30	40	58	250				70.2	64.5	60	54.3	48	40.5	31.5	*
WKL4 100.3 B	37	50	71	260				75.3	69.6	65	59.7	53.7	46.8	38.7	30
WKL4 100.3 A	37	50	71	265				81	75	70.5	65.4	59	52.5	45	36
WKL4 100.4 E	30	40	58	230				74	67.2	62	54.4	46.4	36	24	*
WKL4 100.4 D	30	40	58	240				83.8	76.4	70.8	63.4	55.2	45	33	*
WKL4 100.4 C	37	50	71	250				93.6	86	80	72.4	64	54	42	*
WKL4 100.4 B	45	60	87	260				100.4	92.8	86.8	79.6	71.6	62.4	51.6	40
WKL4 100.4 A	55	75	104	265				108	100	94	87.2	78.8	69.5	59.5	48
WKL4 100.5 E	37	50	71	230				92	84	77.5	68	58	45	30	*
WKL4 100.5 D	45	50	71	240				104	95.5	88.5	79.25	69	56.2	41.2	*
WKL4 100.5 C	45	60	87	250				116	107.5	100	90.5	80	67.5	52.5	*
WKL4 100.5 B	55	75	104	260				125	116.4	108.6	99.5	89.5	78	64.5	50
WKL4 100.5 A	75	100	142	265				134	125	117.5	109	98.5	87.5	75	60
WKL4 100.6 E	45	60	87	230				111	100.8	93	81.6	69.6	54	36	*
WKL4 100.6 D	45	60	87	240				124	114.6	106.2	95	82.8	67.5	49.5	*
WKL4 100.6 C	55	75	104	250				138	128.2	120	108.6	96	81	63	*
WKL4 100.6 B	55	75	104	260				149	139	130.2	119.4	107.4	93.6	77.4	60
WKL4 100.6 A	75	100	142	265				160	150	141	130.8	118.2	105	90	72

H	m	6	15	24	36.5	49	64	79	95	110	125	140	160	Q	m ³ /h	40	80	100	120	140	160	180	200
	ft	20	50	80	120	160	210	260	310	360	410	460	525		g.p.m	150	300	380	454	530	605	680	757

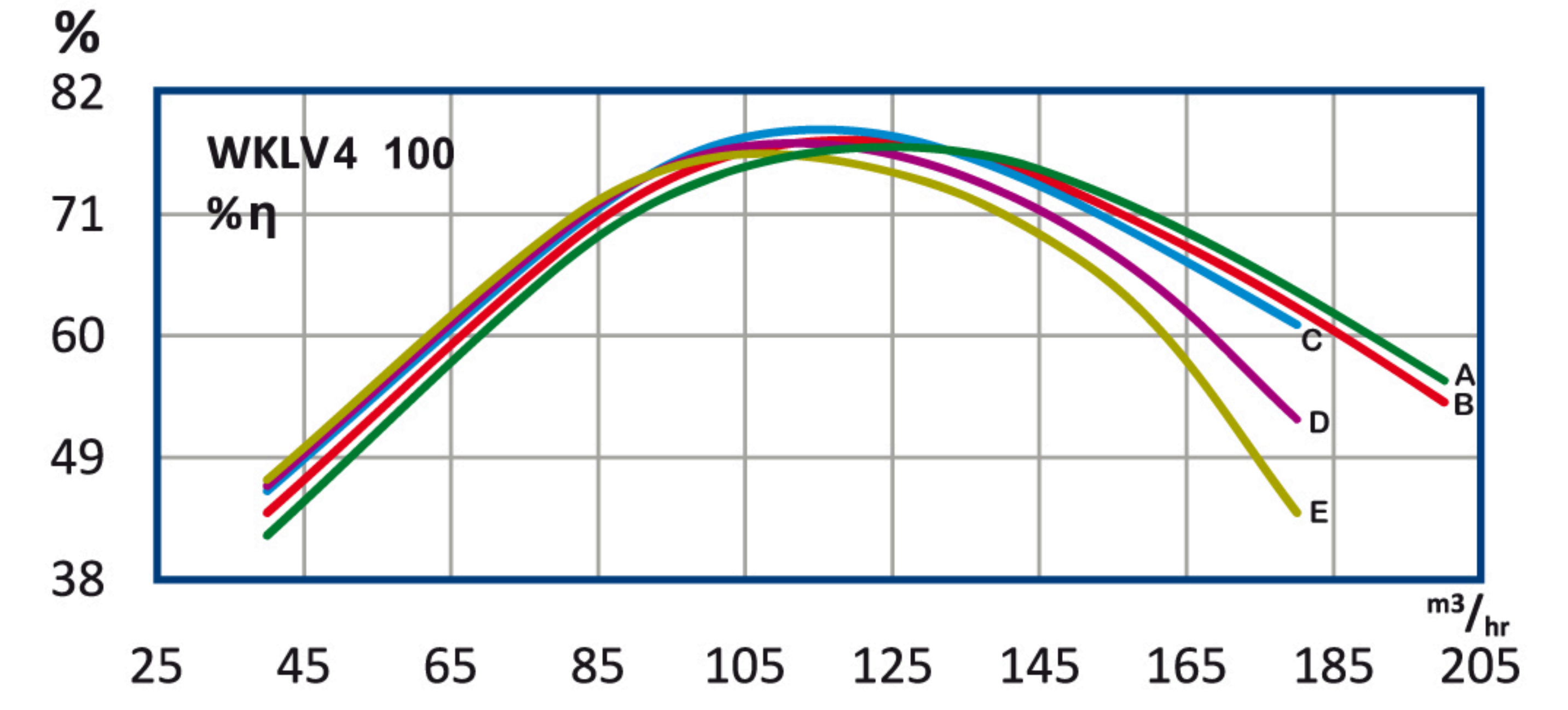
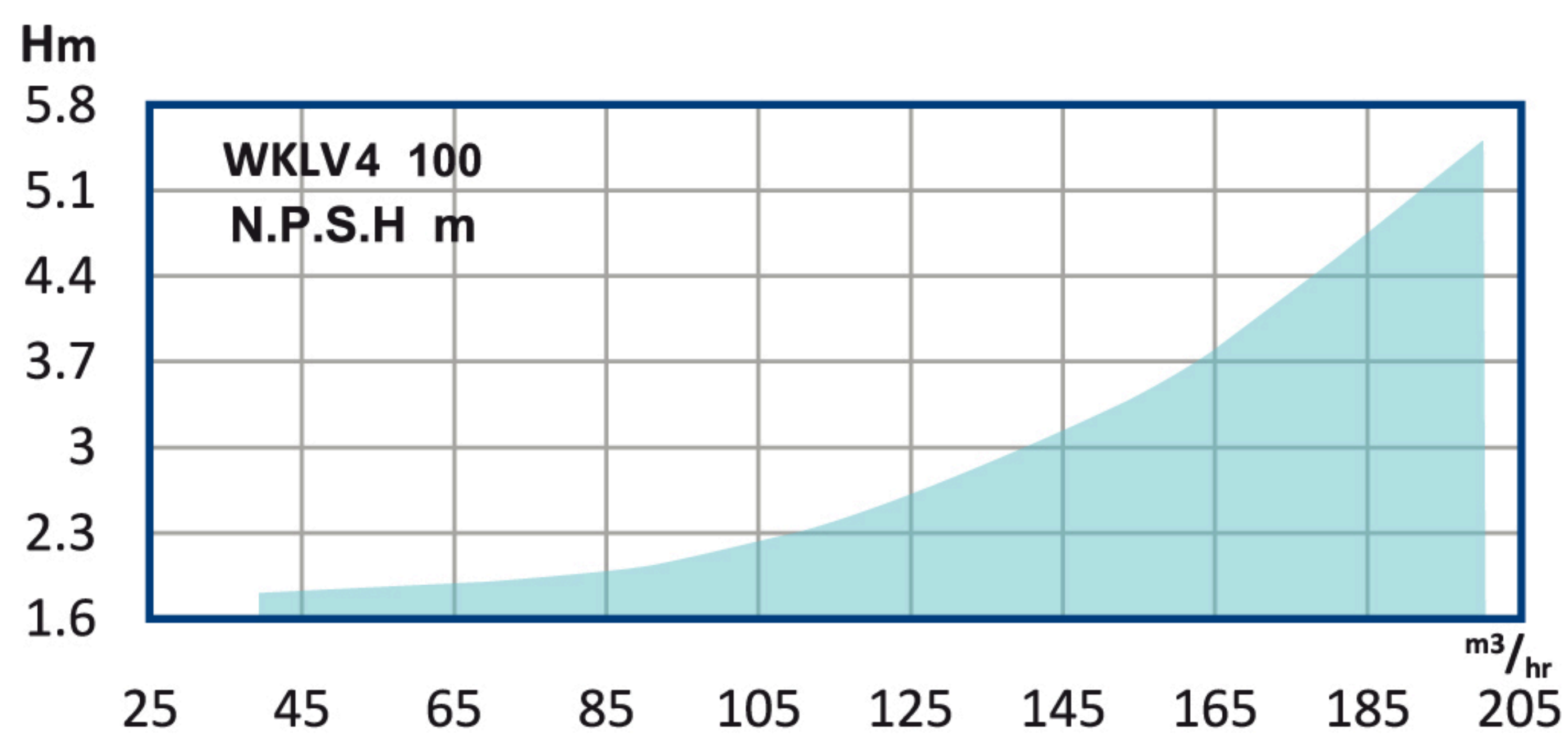
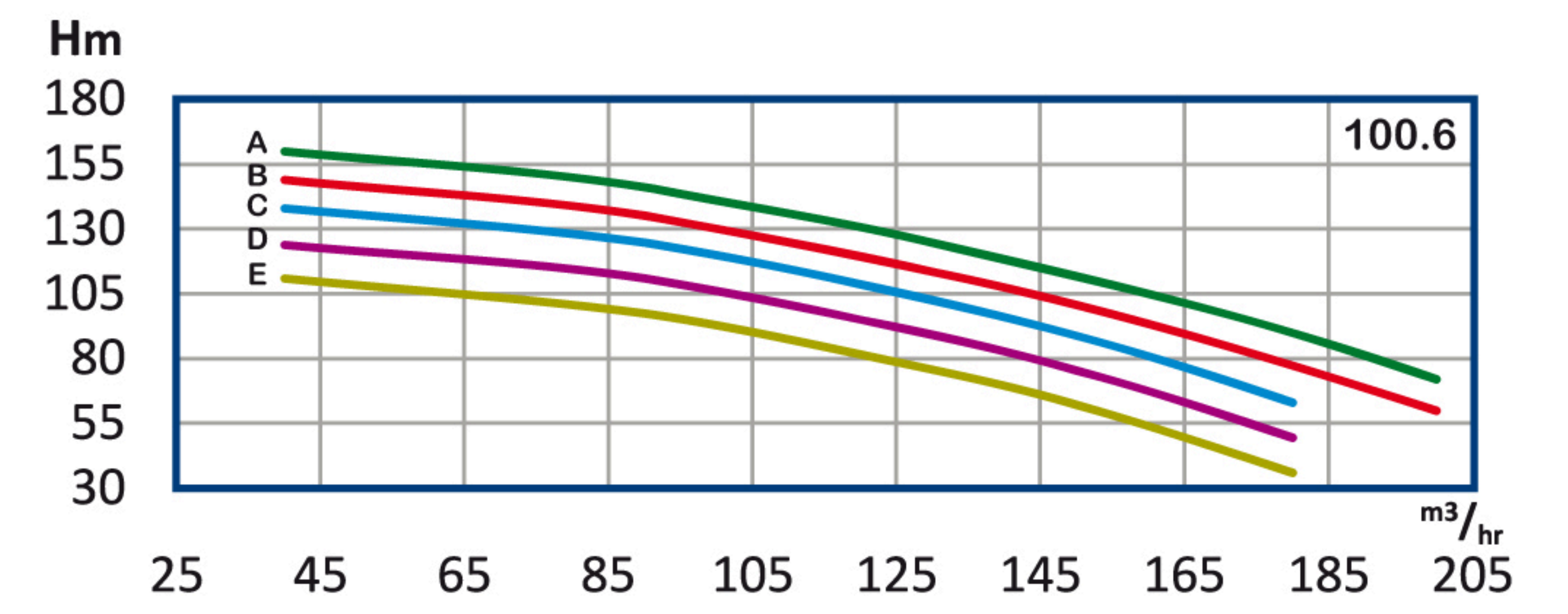
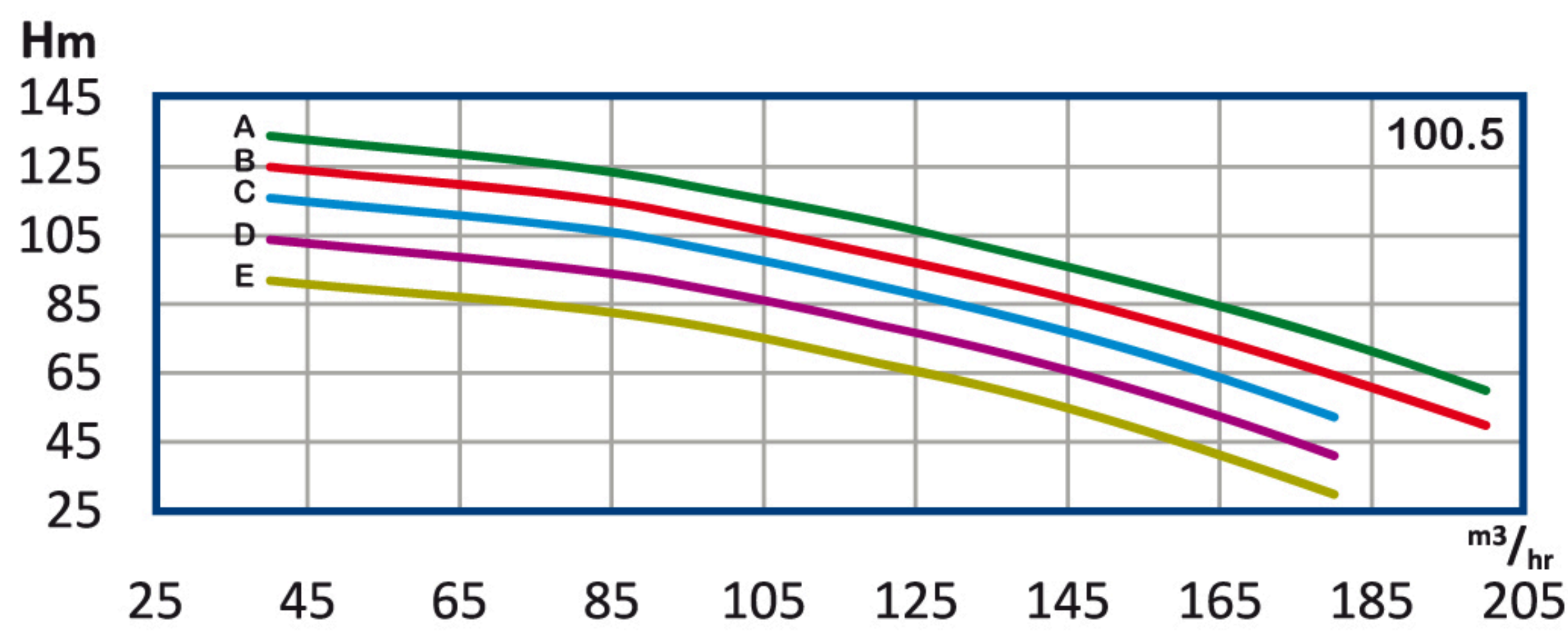
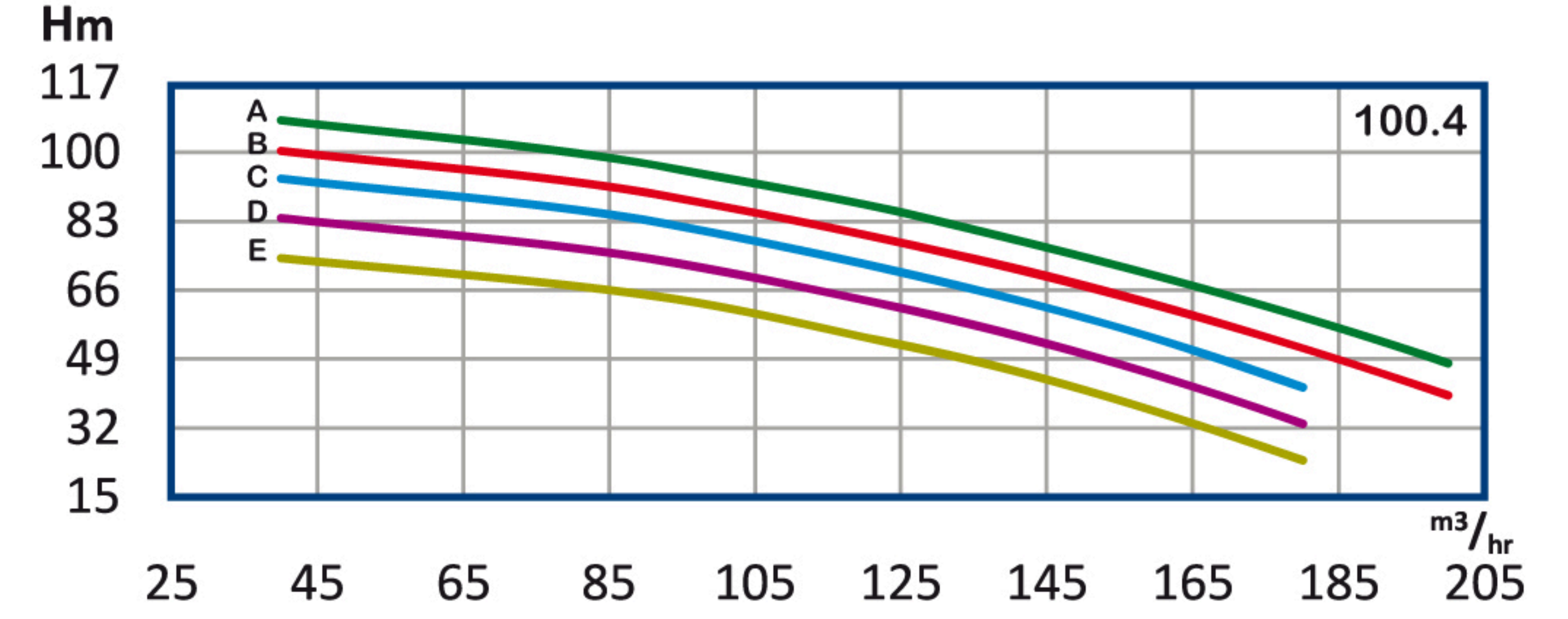
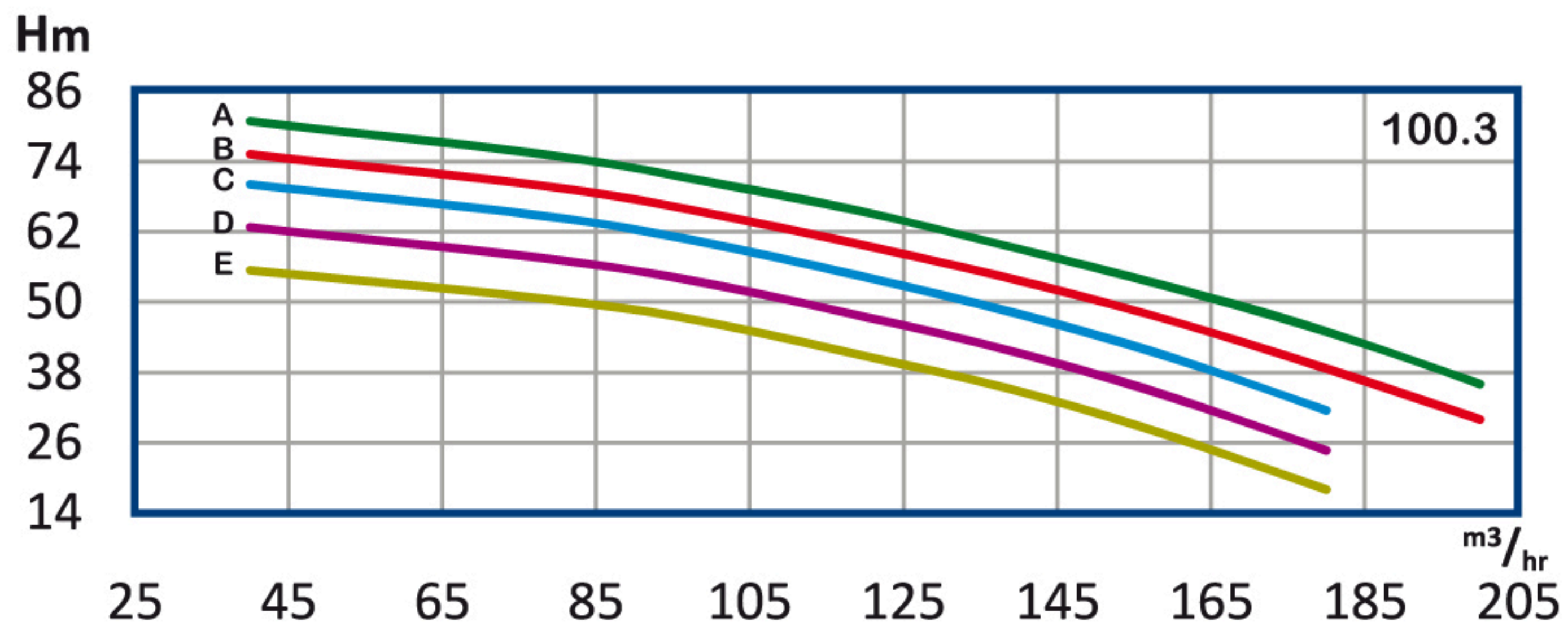
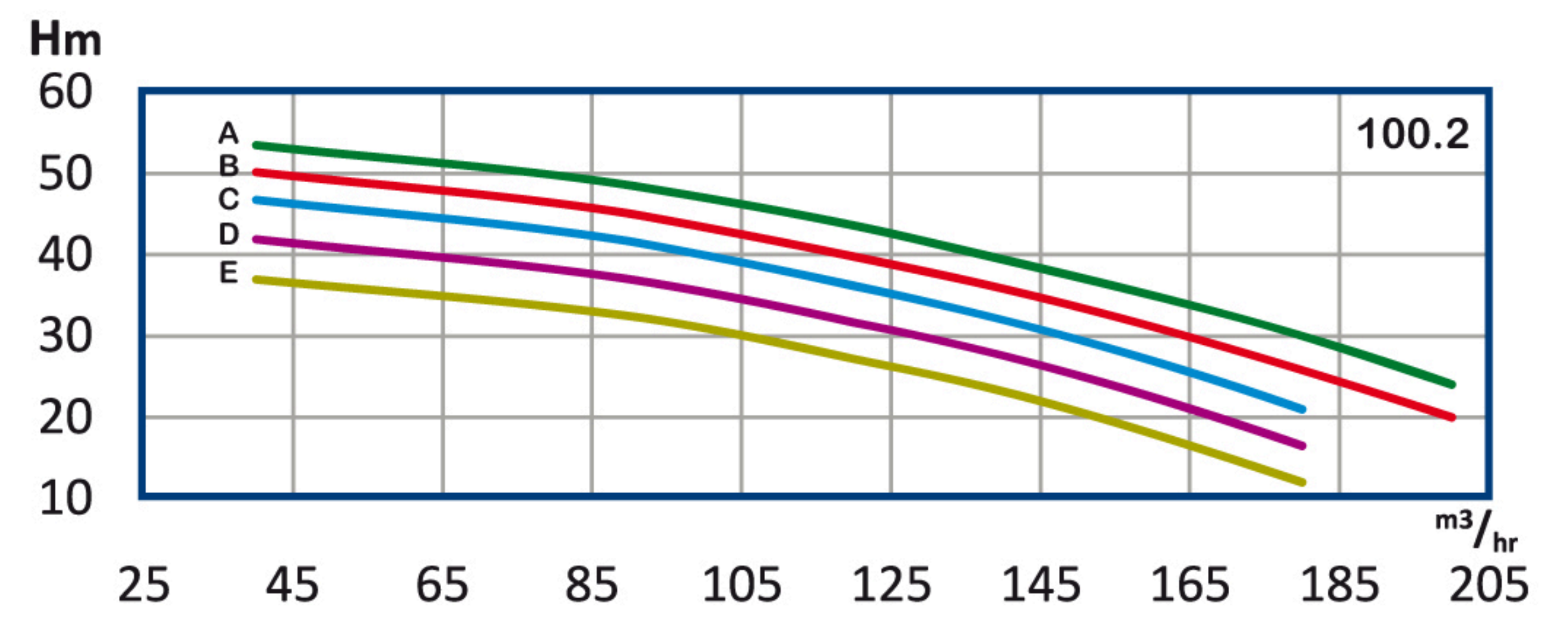
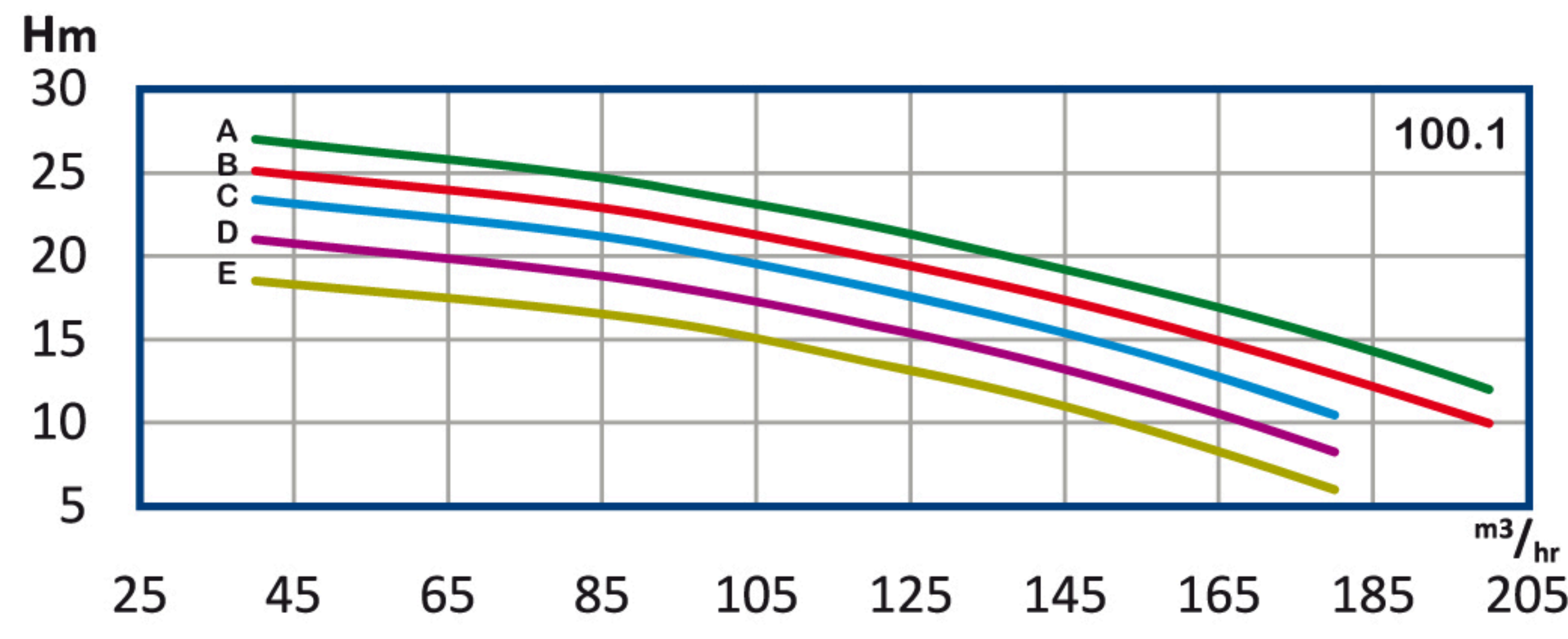

n ≈ 1450 rpm

پمپ WKL4 , WKL 4 100

تیپ پمپ	توان P		آمپر A	قطر پروانه D (mm)	قطر فلنج mm		Q آبدھی								
	KW	HP			مکش	رانس	m ³ /h	40	80	100	120	140	160	180	200
								l/s	11.1	22.2	27.8	33.3	38.9	44.5	50
WKL4 100.7 E	55	75	104	230	125	100	H (m)	129	117.6	108.5	95.2	81.2	63	42	*
WKL4 100.7 D	75	100	142	240				146	133.7	124	111	96.6	78.7	57.7	*
WKL4 100.7 C	75	100	142	250				164	150.5	140	126.7	112	94.5	73.5	*
WKL4 100.7 B	75	100	142	260				175	162.4	152	139.3	125.3	109.2	90.3	70
WKL4 100.7 A	90	125	168	265				188	175	164.5	152.6	138	122.5	105	84
WKL4 100.8 E	55	75	104	230				148	134.4	124	108.8	92.8	72	48	*
WKL4 100.8 D	75	100	142	240				167	152.8	141.6	126.8	110.4	90	66	*
WKL4 100.8 C	75	100	142	250				186	171	160	144.8	128	108	84	*
WKL4 100.8 B	90	125	168	260				200	185	173.6	159.2	143.2	124.8	103.2	80
WKL4 100.8 A	110	150	205	265				215	200	188.5	174.4	157.6	140	119	96
WKL4 100.9 E	60	80	124	230				166	151.2	139.5	122.4	104.4	81	54	*
WKL4 100.9 D	60	80	124	240				188	172	159.3	142.7	124.2	101.3	74.2	*
WKL4 100.9 C	90	125	168	250				210	193.5	180	163	144	121.5	94.5	*
WKL4 100.9 B	110	150	205	260				225	208.8	195.3	179	161	140.4	116	90
WKL4 100.9 A	110	150	205	265				242	225	211.5	196.2	177.3	157.5	135	108
WKL4 100.10 E	75	100	142	230				185	168	155	136	116	90	60	*
WKL4 100.10 D	90	125	168	240				208	191	177	158.5	138	112.5	82.5	*
WKL4 100.10 C	90	125	168	250				233	215	200	181	160	135	105	*
WKL4 100.10 B	132	180	245	260				250	232	217	199	179	156	129	100
WKL4 100.10 A	132	180	245	265				268	250	236	218	197	175	150	120

H	m	40	58	76	98	119	140	162	183	206	229	252	275
	ft	130	190	250	320	390	460	530	600	675	750	825	900

Q	m ³ /h	40	80	100	120	140	160	180	200
	g.p.m	150	300	380	454	530	605	680	757

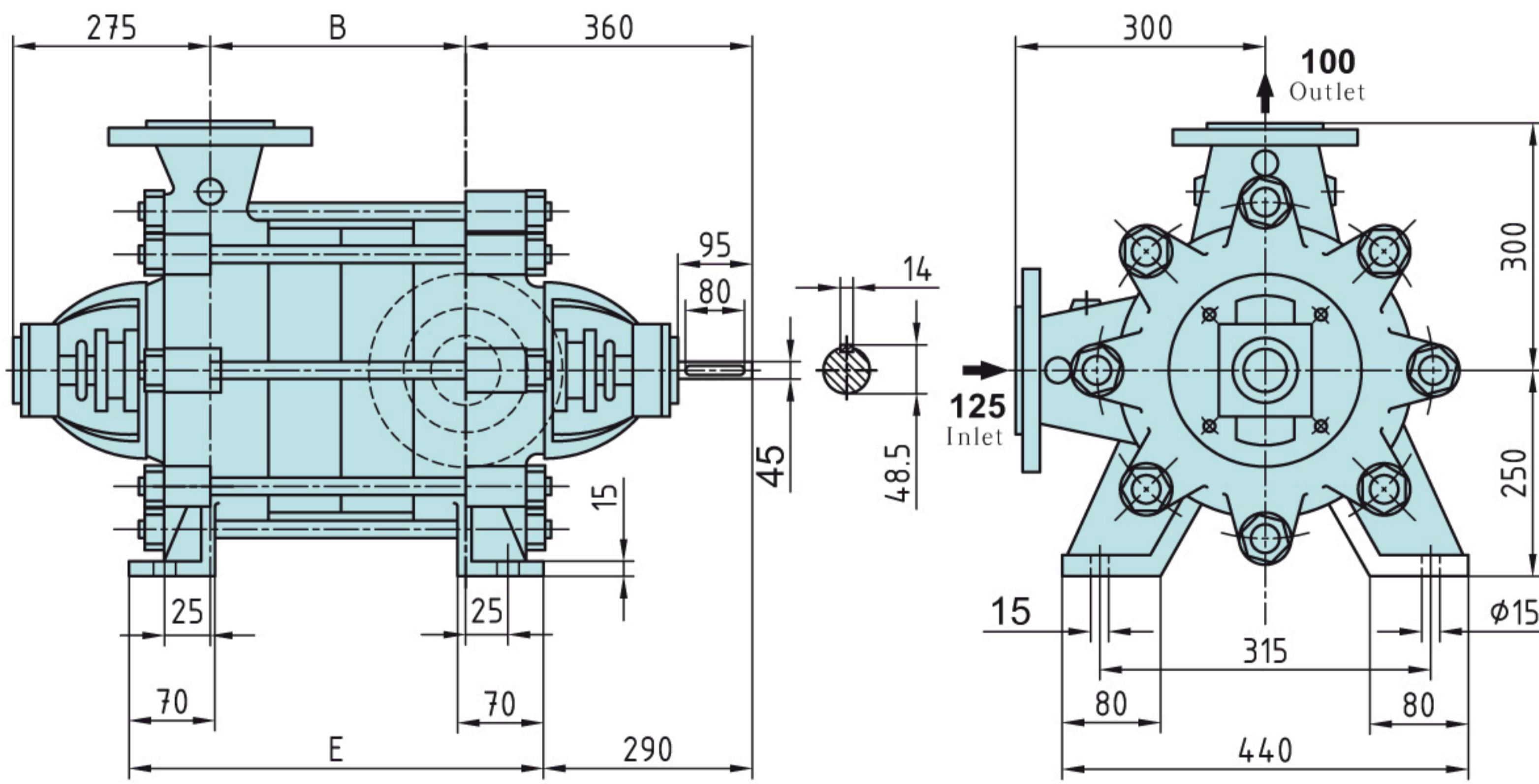
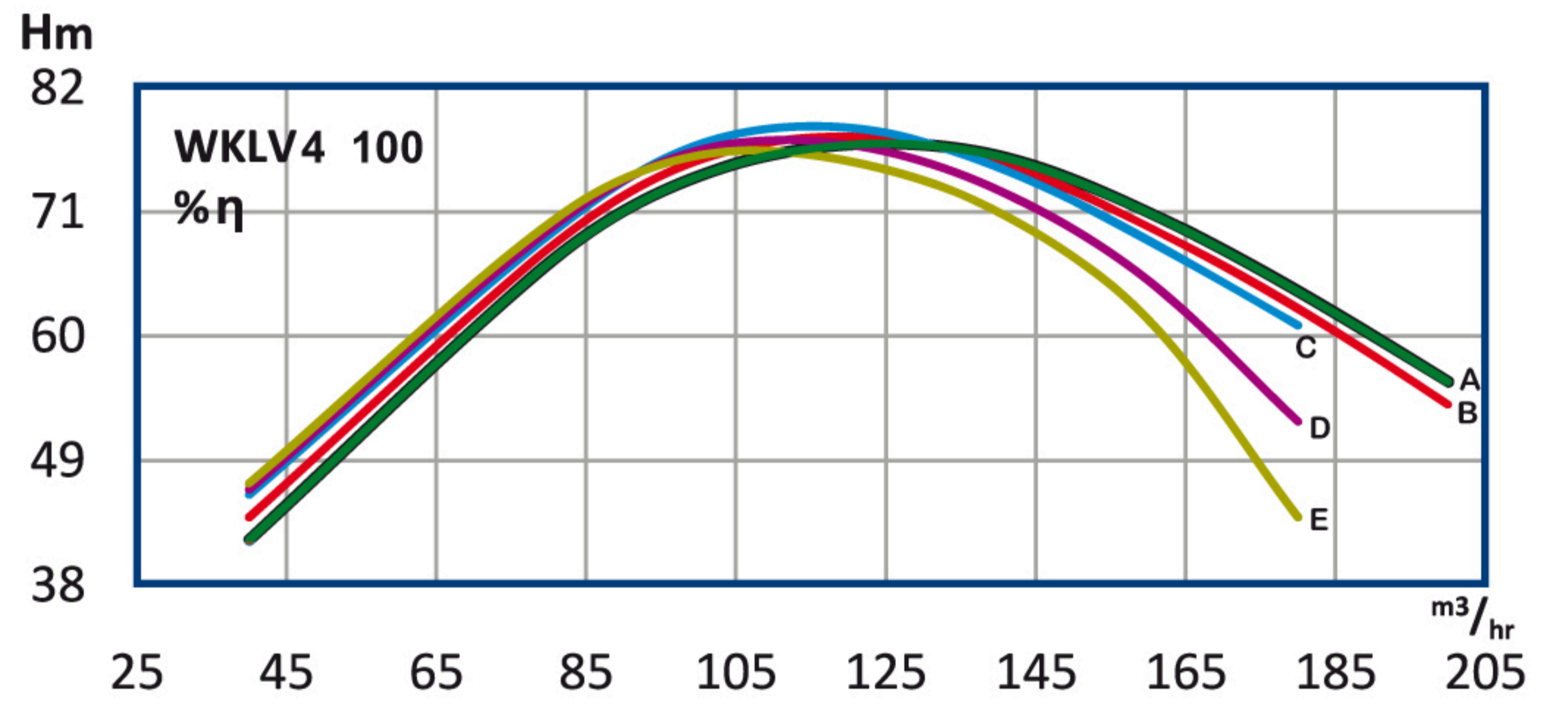
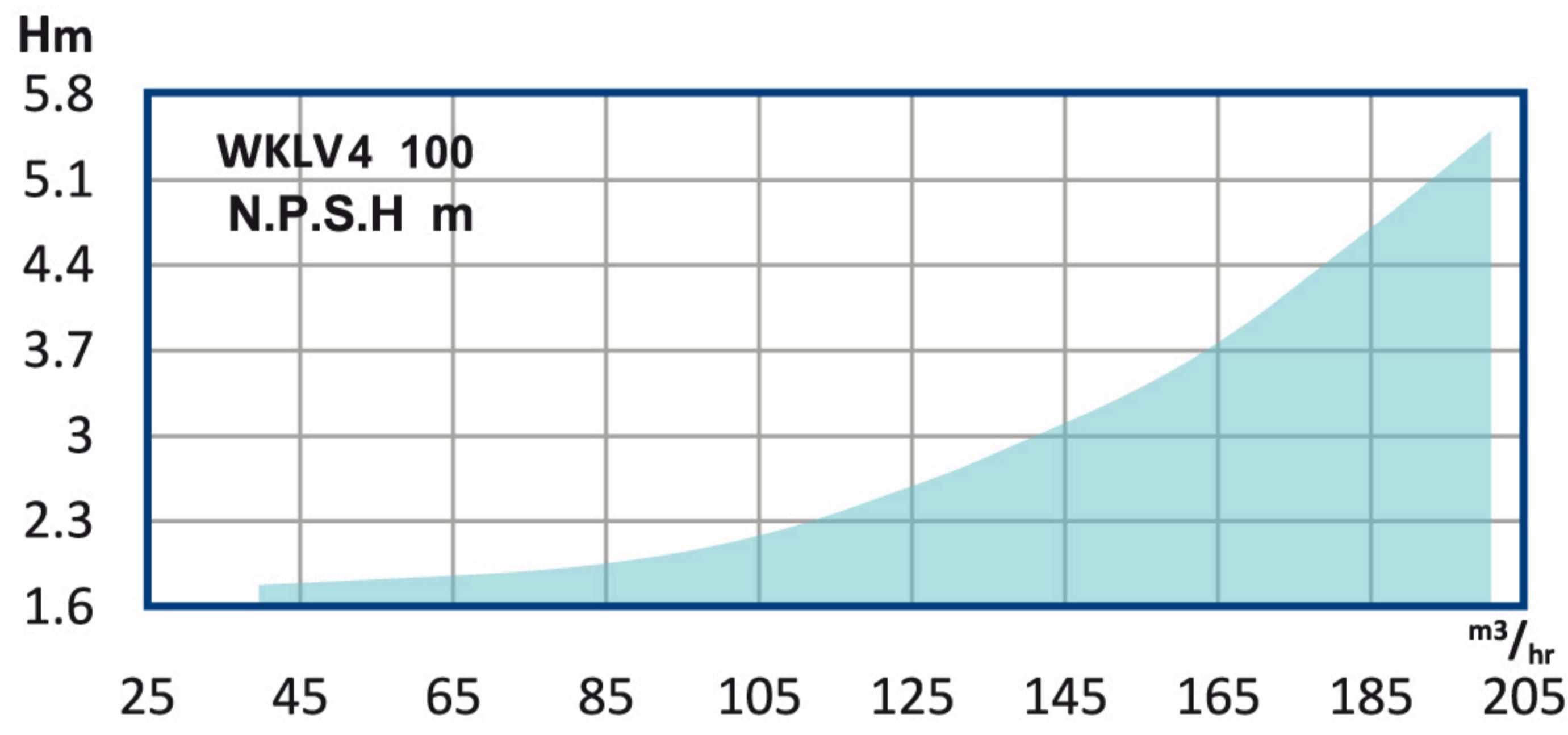
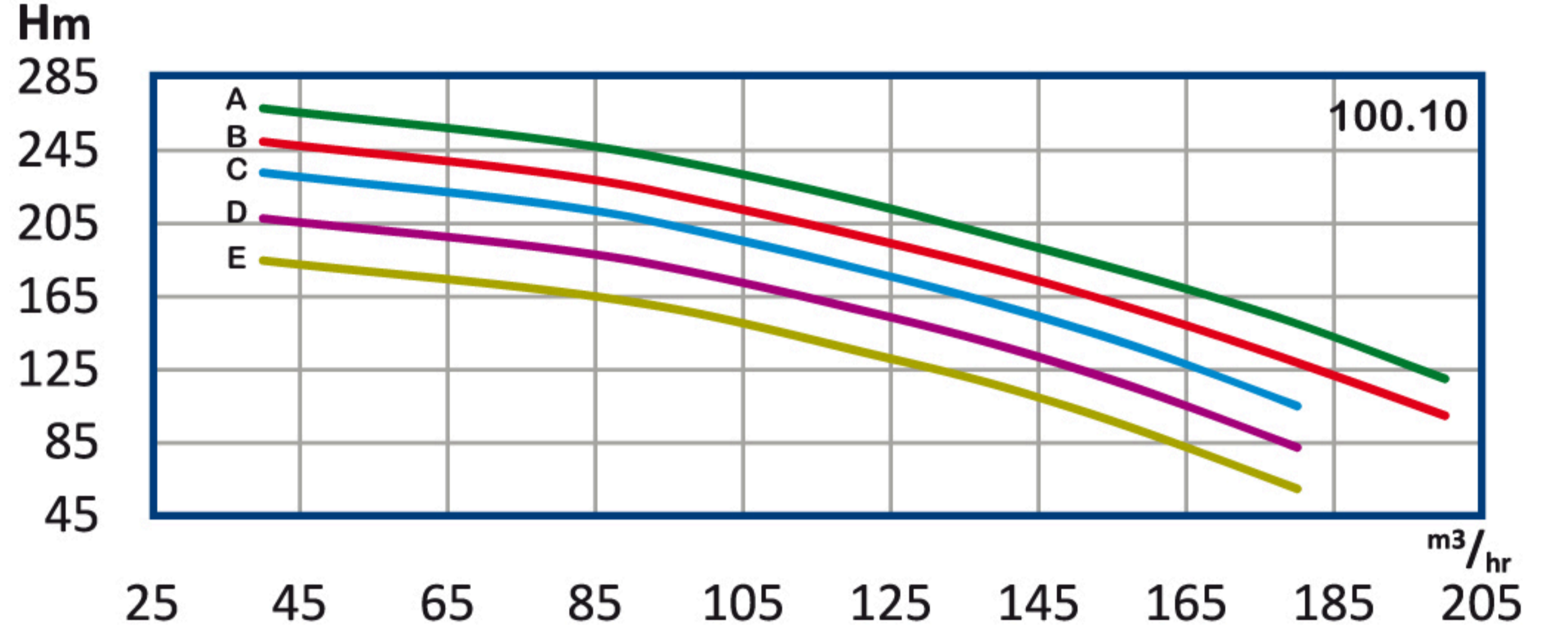
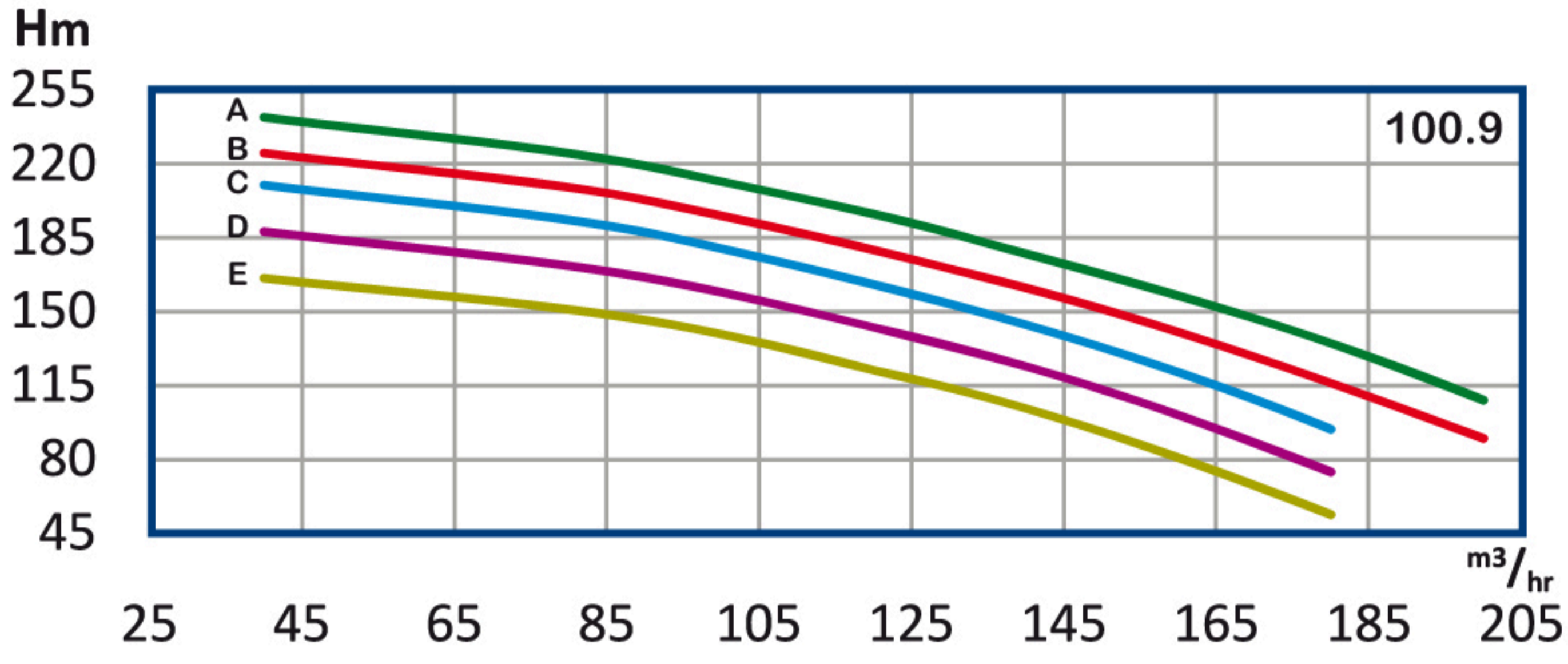
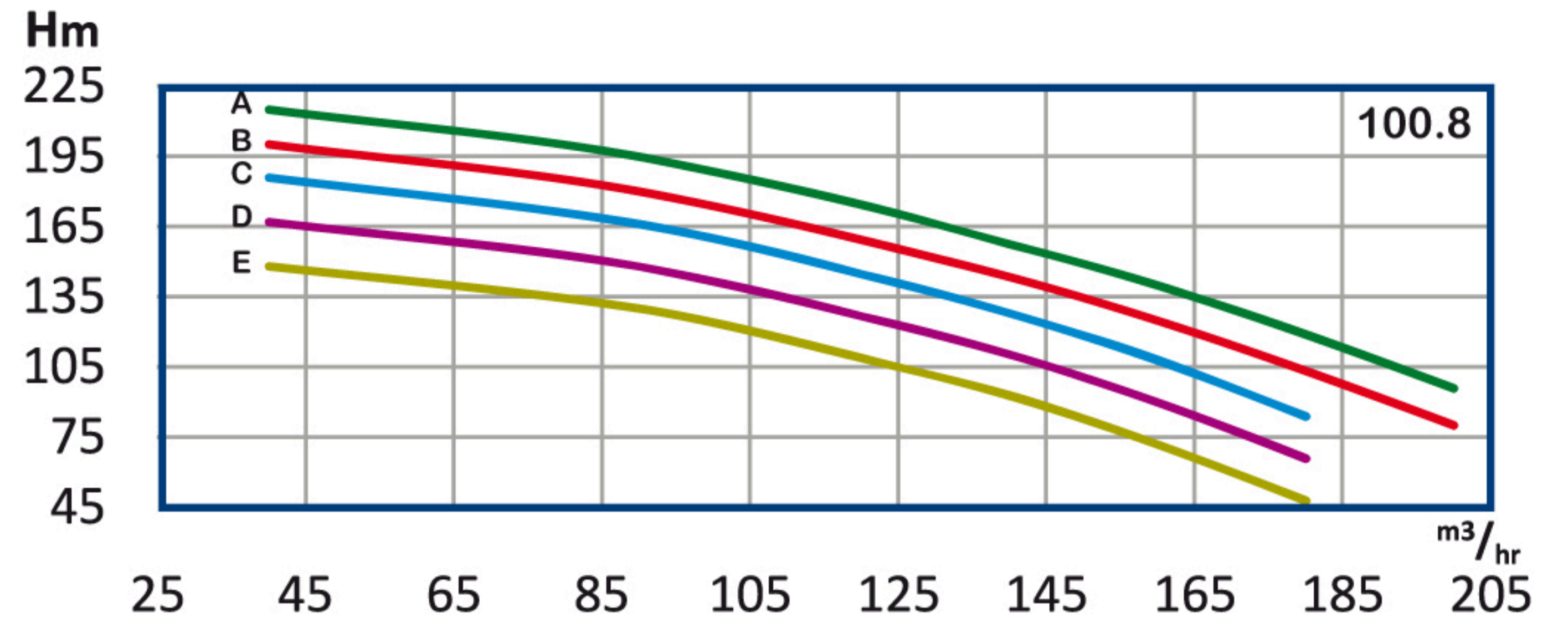
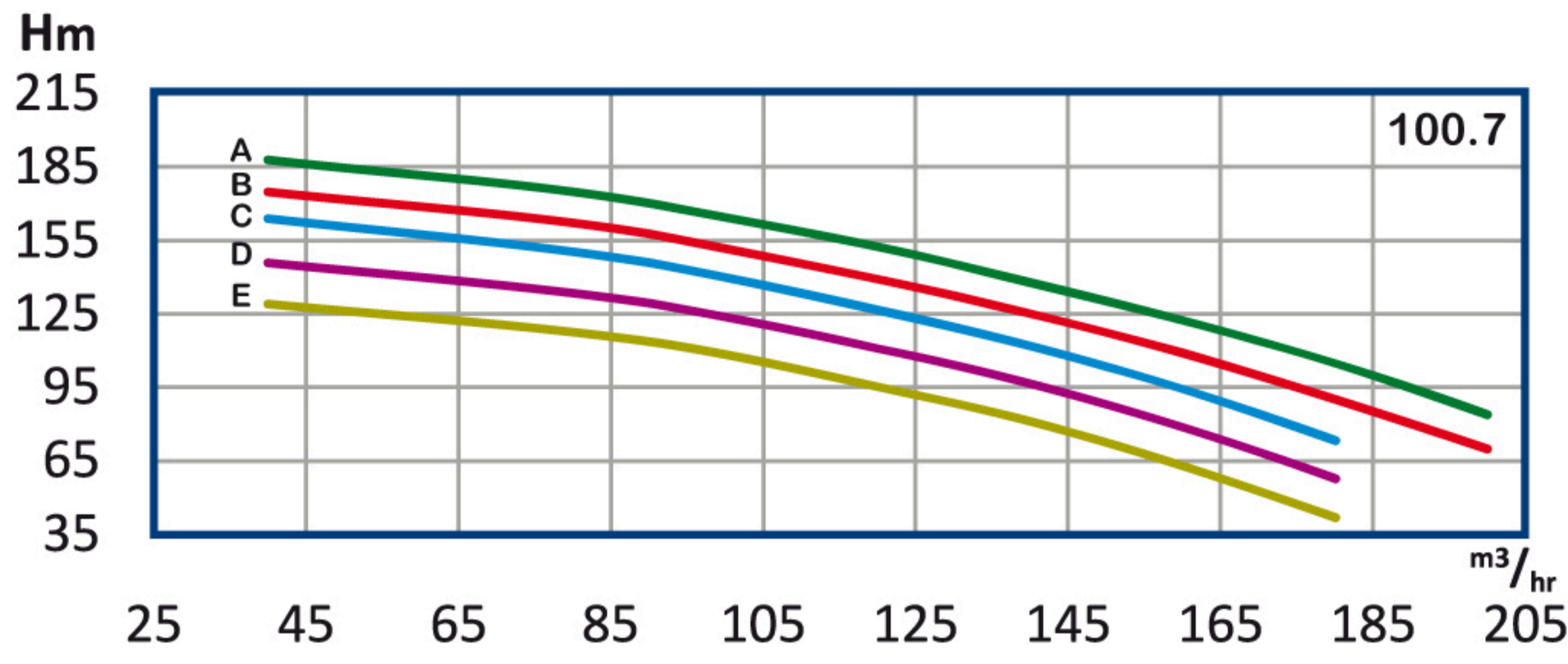

جدول طول پمپ WKL4 100 (mm)

تعداد طبقه	B	E	تعداد طبقه	B	E
1	135	275	6	635	775
2	235	375	7	735	875
3	335	475	8	835	975
4	435	575	9	935	1075
5	535	675	10	1035	1175

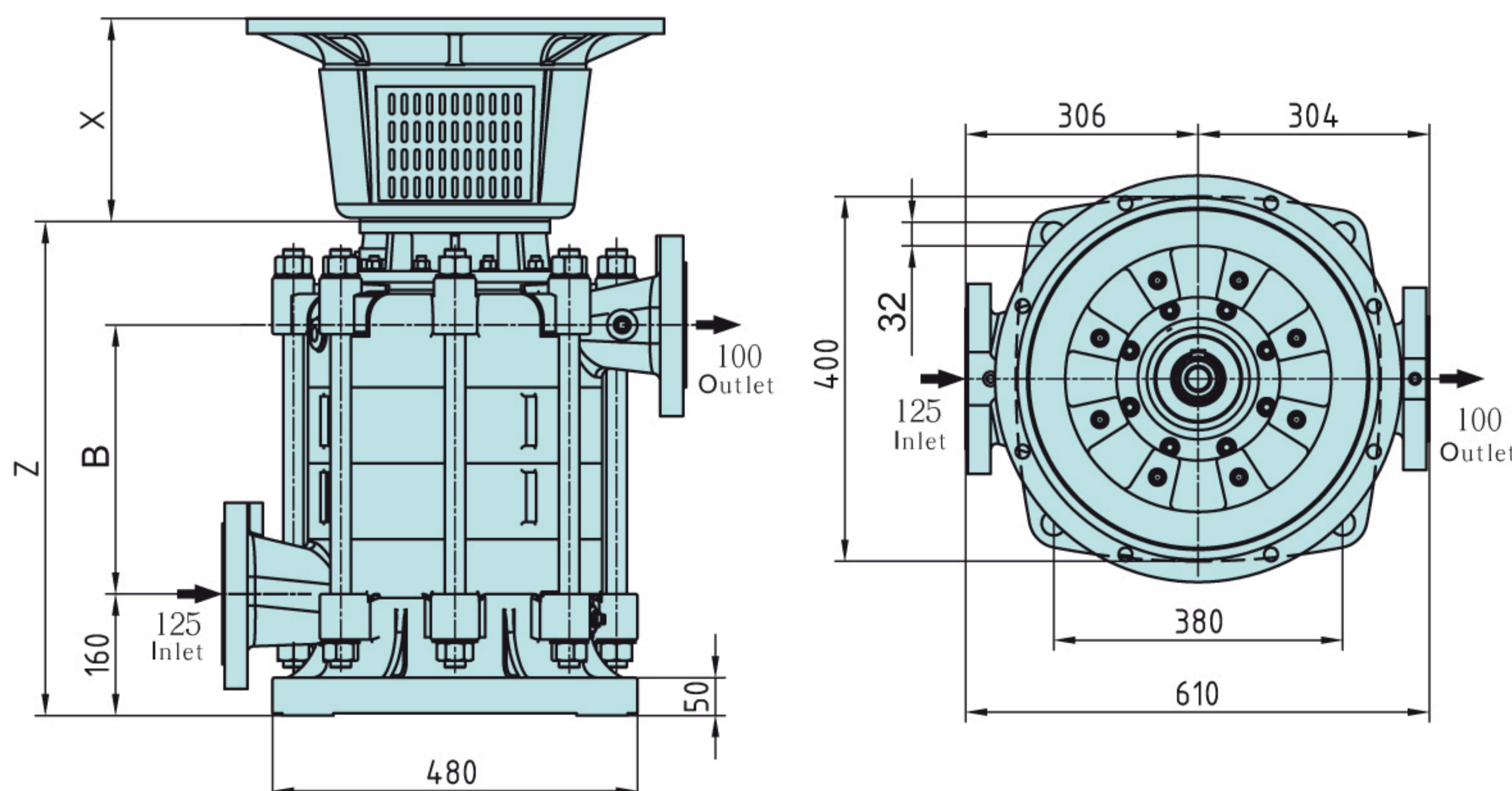

جدول طول پمپ WKL4 100 (mm)

تعداد طبقه	B	Z	تعداد طبقه	B	Z
1	154	480	6	654	980
2	254	580	7	754	1080
3	354	680	8	854	1180
4	454	780	9	954	1280
5	554	880	10	1054	1380

X: متناسب با قدرت الکترو موتور تغییر می یابد.

جدول ابعاد پمپ های (80-150) WKLV4 , WKLV

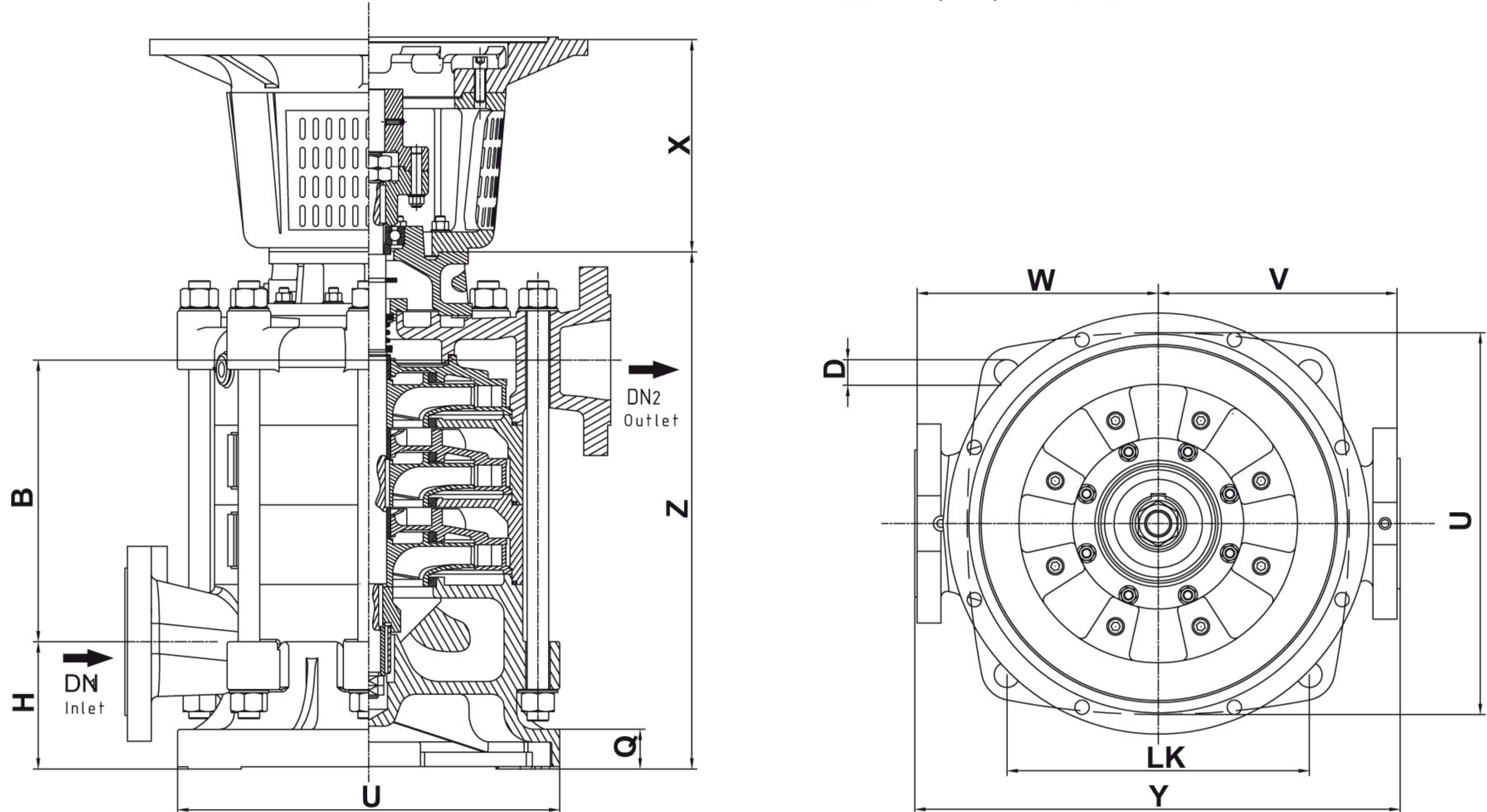

Type	(mm)									
	DN1	DN2	LK	Y	U	D	W	V	Q	H
WKLV4 / WKLV 80	100	80	324	526	400	24	260	260	45	162
WKLV4 100	125	100	380	610	480	32	303	300	50	160
WKLV4 125	150	125	523	769	660	40	385	384	85	249
WKLV4 150	200	150	545	865	685	40	430	435	85	276

Type	طول پمپ	(mm)											
		1	2	3	4	5	6	7	8	9	10	11	12
WKLV4 / WKLV 80	B	95	178	261	344	427	510	593	676	759	842	925	1009
	Z	401	484	567	650	733	816	899	982	1065	1148	1231	1314
WKLV4 100	B	154	254	354	454	554	654	754	854	954	1054	*	*
	Z	450	550	650	750	850	950	1050	1150	1250	1350	*	*
WKLV4 125	B	172	287	402	517	632	747	*	*	*	*	*	*
	Z	631	746	861	976	1091	1206	*	*	*	*	*	*
WKLV4 150 Type A	B	214	359	504	649	794	939	*	*	*	*	*	*
	Z	750	895	1040	1185	1330	1475	*	*	*	*	*	*
WKLV4 150 Type B	B	214	359	504	649	794	939	*	*	*	*	*	*
	Z	730	875	1020	1165	1310	1455	*	*	*	*	*	*